



## The Community-Built Process:





Step 1: Create a Committee:



The community-built process begins with a committee of volunteers, usually between 10 and 15 people.



## Subcommittees:

General Coordinators  
Volunteers Coordinator  
Fundraising Coordinator  
Publicity Coordinator  
Donated Materials Coordinator  
Purchased Materials Coordinator  
Tools Coordinator  
Food Coordinator  
Childcare Coordinator  
Special Needs Coordinator  
Site Coordinator  
Construction Crew Supervisors  
Children's Representatives



Don't worry, you're not reinventing the wheel. PBD is here to help guide you through the process.



## Step 2: Design Day

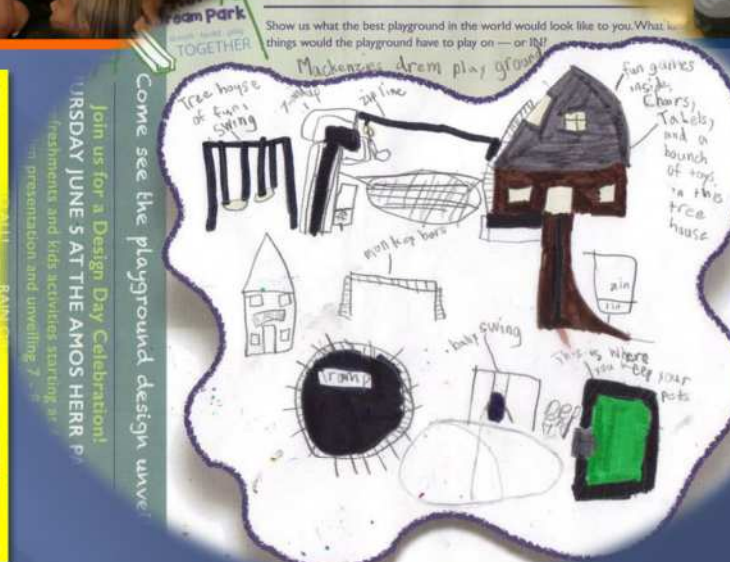

Play by Design visits your town to interview children and adults in order to develop your design. In the evening, we help you "kick off" the project with a celebratory meeting/celebration with families and interested community members. This get-together serves as a rallying point for the volunteer effort, galvanizing the community with the vision of their children's dreams. We will have many phone conversations before this visit, giving you a suggested schedule and ideas for activities.



## Step 3: Prepare for the Build:

We then work closely with you to prepare to build your playground. We help you organize the committee and show you ways to raise funds, publicize the project, and continue to recruit many volunteers.

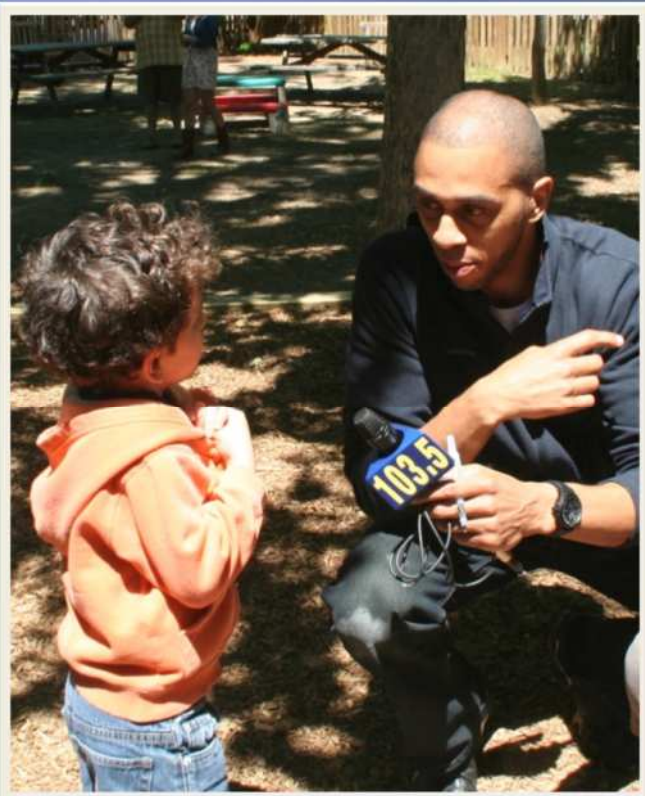



## Step 4: Pre-Construction Visit:

About 8 to 10 weeks before construction is scheduled to begin, we will return to your community to review your preparations to date and strategize the final weeks before construction. We will lay out a site plan and review schedules, volunteer numbers, and progress of all committees.





## Step 5: The Community Build Build:

Two or three Play by Design consultants return to supervise the volunteers who will build your playground. We have many years of experience organizing hundreds of volunteers. Based on their skill level, we separate them into small groups to work on individual components of the project.





Your site could look like this on the first day...





...and the children get to play on the playground their parents built!





# Why Community Built?

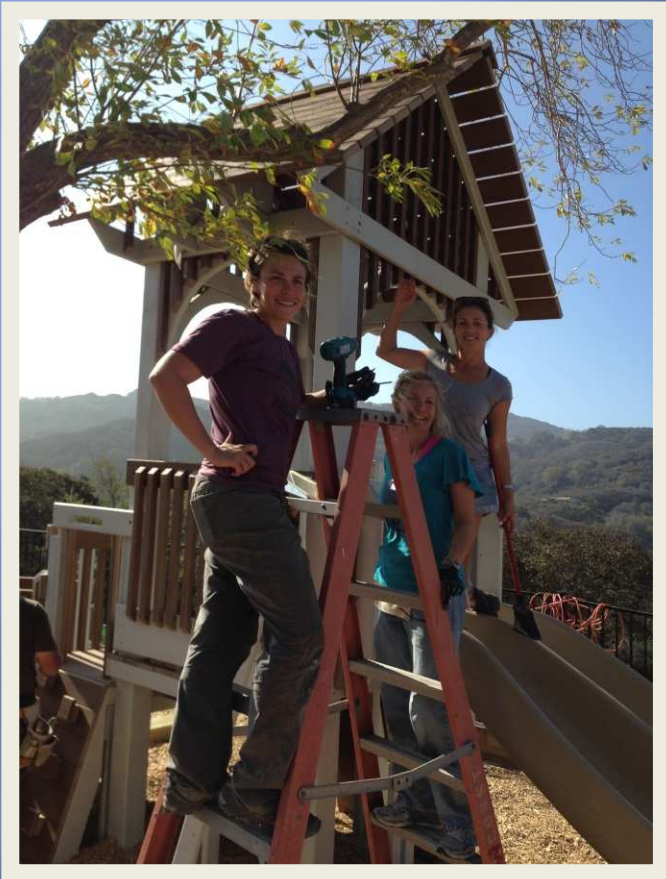

## Cost Savings

Simply put, affordability—you get a lot more bang for your buck. The value of the structure will be at least double its cost. We build projects for all budgets, and volunteer labor, as well as donated or discounted materials, add to your savings.





### Community pride

People of all ages who may not normally interact come together to build the structure. At the conclusion, there is an opening celebration, and everyone involved walks away with a sense of ownership and accomplishment.





**sight lines:** being able to see your children while they are playing is important. With custom playgrounds, we can design them as open as you want them to be.







## Material Options

We use various materials based on your budget. The most maintenance-friendly designs use structural plastic lumber along with plastic composite lumber. We also use environmentally friendly and arsenic-free pressure-treated lumber. There are many types of safety surfacing options, all of which meet ASTM standards for impact attenuation and accessibility. Some of the materials that we specify can be found locally.





## Safety

All designs are in compliance with ASTM International and Consumer Product Safety Commission (CPSC) standards and guidelines. They also meet the ADA's accessibility guidelines. Our designers and builders are certified as playground safety inspectors (CPSIs) by the National Recreation & Parks Association.





### **Maintenance:**

Our most maintenance-friendly designs use structural plastic lumber along with plastic composite lumber. We also use environmentally friendly and arsenic-free pressure-treated lumber. Safety surfacing—on all playgrounds, manufactured or site-built—is the largest maintenance concern.





### Accessibility: All-Inclusive Play

All designs meet current ASTM and CPSC safety guidelines as well as the Americans with Disabilities Act Accessibility Guidelines. Safety surfacing also meets ASTM guidelines for impact attenuation and accessibility. Custom designs allow children of all abilities design ways to play with their friends being all inclusive.





### Age-Appropriate:

We design age-appropriate areas that avoid conflicting activities. Signs delineate areas for children aged 2 to 5 and for those aged 5 to 12. Playground rules signs include the need for adult supervision. We also believe in cross-generational play. There's something for everyone.























# Wellness Playgrounds for Elders:

Imagine a beautiful place, ...





... custom-designed...





... to exercise, ...



Our designs target the therapeutic exercises most important for the ability of elders to stay actively engaged daily:

- Extending range of motion
- Improving balance
- Building muscle strength
- Promoting cardiovascular health
- Enhancing fine motor coordination





... socialize,...



Our playgrounds for elders deliberately encourage social interaction:

- Safe, attractive and peaceful gardens, with shelters, conversational seating nooks, and wide walking paths
- Activity equipment designed for face-to-face usage
- Games like chess, cards, bocce, and ping-pong
- Spaces for yoga or tai chi
- Acoustic performance spaces for both observing and performing



... and play.

- The myriad benefits of physical exercise and social interaction are multiplied and deepened by providing such opportunities in a playful, lighthearted setting.
- Playing relieves stress and improves mood.
- By designing the whole experience to be enjoyable and playful, elders will visit, participate, and return, often inviting friends and family.





Wellness Playgrounds  
for Elders, ...

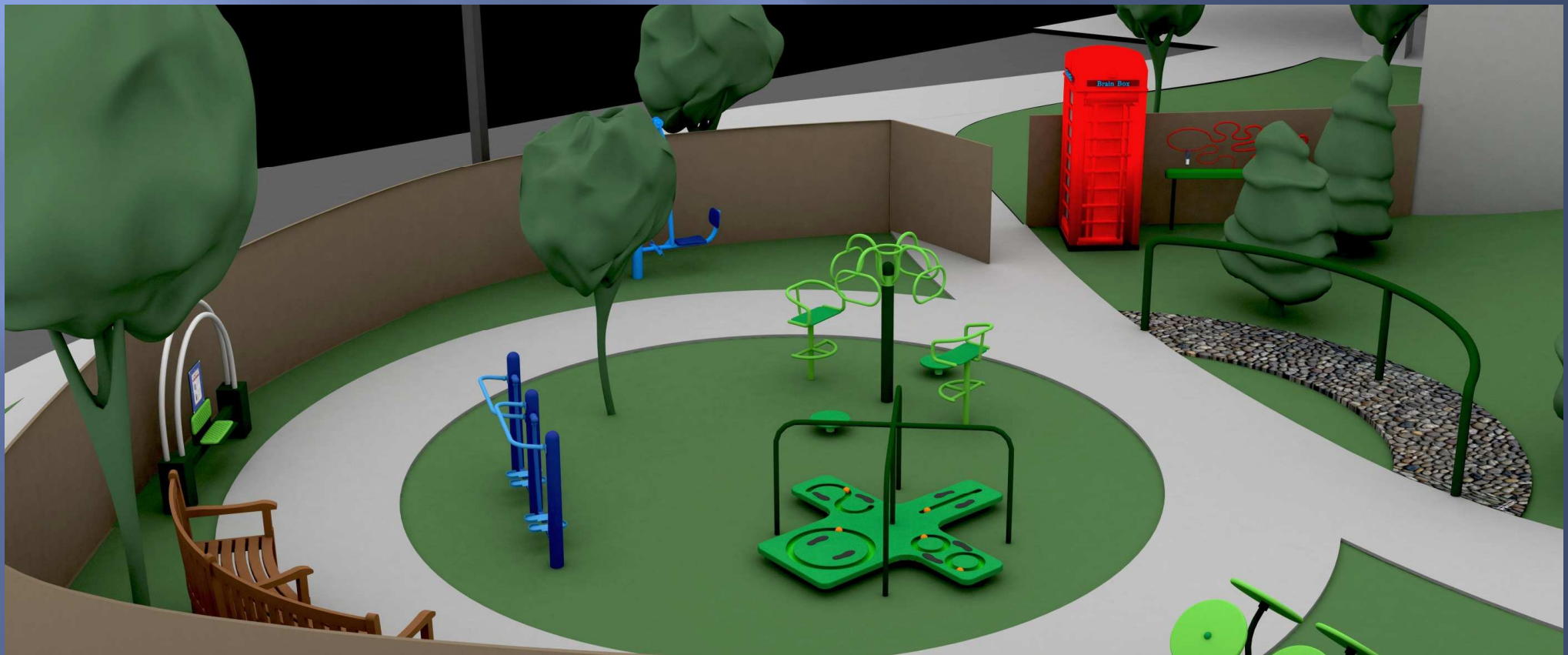



## **\*REFERENCES \***

### **Ipswich Community Playground at Winthrop Elementary; Ipswich, MA**

Charles Whitten, General Coordinator

[cwhitten@juniperllc.com](mailto:cwhitten@juniperllc.com)

(617) 962-1022

### **WOW: World of Wonders Playground; City of Tomah, Wisconsin**

Joe Protz, Director of Parks and Recreation, City of Tomah

[jprotz@ci.tomah.wi.us](mailto:jprotz@ci.tomah.wi.us)

(608) 374-7445

### **HoPP: Homer Playground Project; City of Homer, Alaska**

Miranda Weiss, General Coordinator

[mirandaweiss@gmail.com](mailto:mirandaweiss@gmail.com)

(907) 299-5550

### **Sherwood Forest Playground; East Grand Forks, Minnesota**

Penny Pape, General Coordinator

[pennypape@hotmail.com](mailto:pennypape@hotmail.com)

(218) 773-7387

### **Puma Park; Truro, Massachusetts**

Curtis Hartman, General Coordinator, Head Selectman, Truro, MA

[curtis.hartman22@gmail.com](mailto:curtis.hartman22@gmail.com)

(508) 680-2259

### **Joey's Park, Belmont, Massachusetts**

Diane Miller

[diane@millerdesignllc.com](mailto:diane@millerdesignllc.com)

(617) 993-3157, (781) 696-6807

Ellen Schreiber

[ellensch@verizon.net](mailto:ellensch@verizon.net)

(617) 290-6216



## Our Guarantee

### **Play By Design, LLC**

119 West Buffalo Street  
Ithaca, NY 14850  
607.351.5160

Website: [www.PBDplaygrounds.com](http://www.PBDplaygrounds.com)  
Facebook: [www.facebook.com/pages/  
Play-by-Design-LLC/174958729219124](https://www.facebook.com/pages/Play-by-Design-LLC/174958729219124)



Play by Design is fully insured. We guarantee the craftsmanship and quality of our playgrounds. Specified materials carry the manufacturer's warranty. We comply with all ASTM, CPSC and ADA standards and guidelines. We stand behind our product. For the life of the playground, our maintenance department is available to address concerns and answer questions.